



The Official Shipping Container-Based Structures Supplier

Elevate the Fan Experience with
Container-Based Structures

STADIUM TOOLKIT





TABLE OF CONTENTS

<u>Fan Bathrooms</u>	1-5
<u>VIP Suites</u>	7-8
<u>Concessions</u>	9-10
<u>Press Boxes</u>	11-12
<u>Locker Rooms</u>	14-15
<u>Team Offices</u>	16-18
<u>Custom Projects</u>	19



Structure Solutions That Grow With Your Team

Scalable | Easy to Set Up | Relocatable

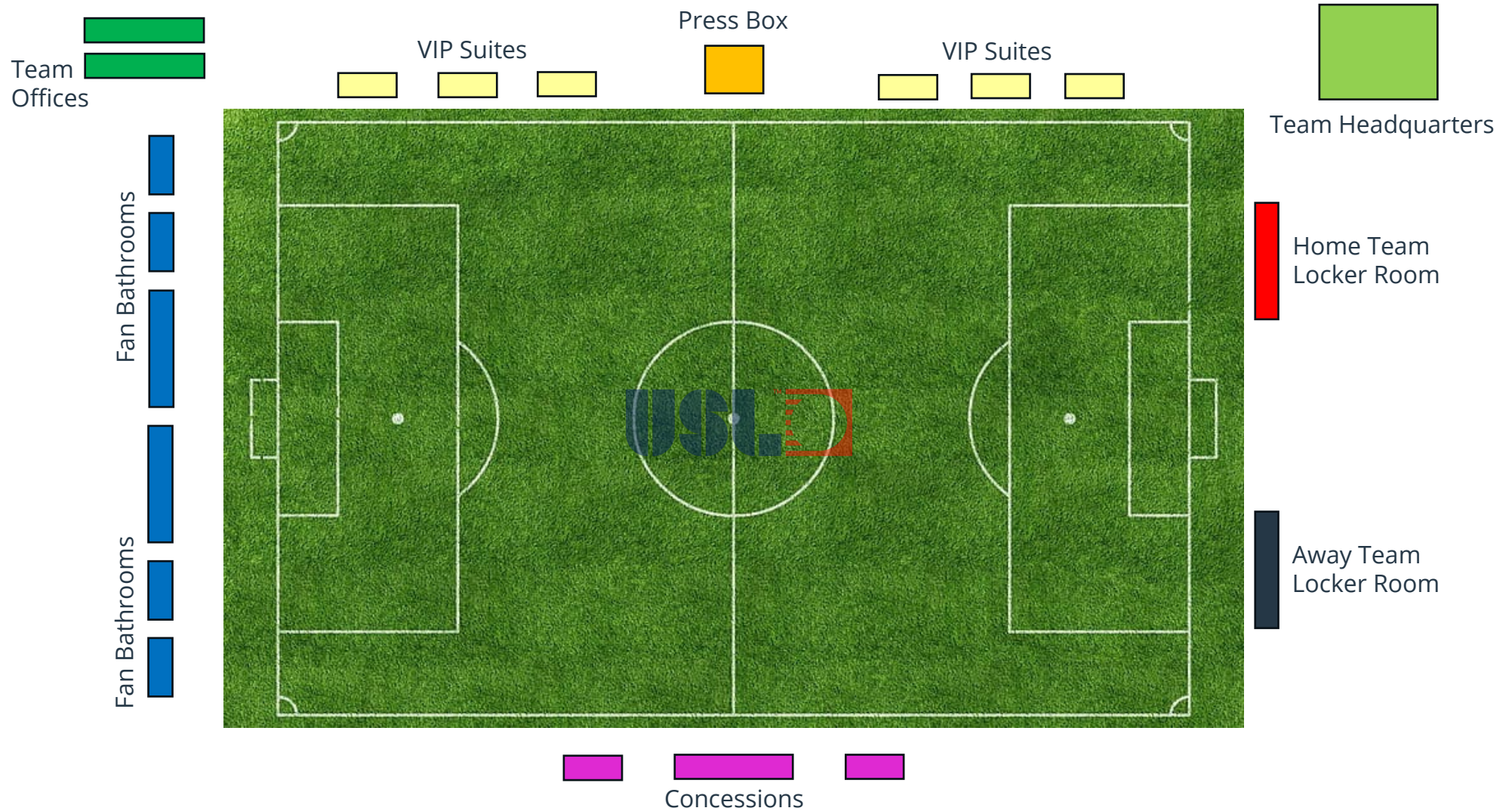

FAN BATHROOMS

Modular Fan Amenities

- Set up easily
- Clean & climate controlled
- Relocate as needed
- Preferred over portable toilets
- Customize with team colors



Women's Restroom

Item 9501313 – Model D2400

- 4 toilets
- 2 sinks
- Climate controlled
- 8' x 20' - 160 sf

Pricing starts at \$31,800

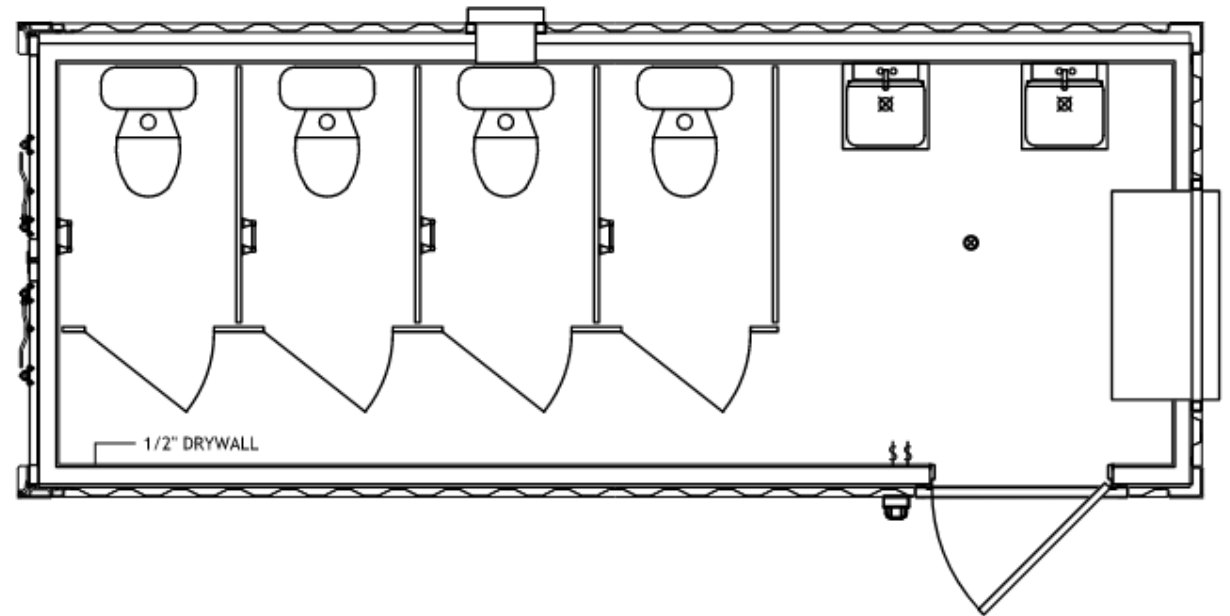

ARCHITECTURAL FLOORPLAN

Men's Restroom

Item 9501301 – Model D2230

- 3 urinals
- 2 toilets
- 2 sinks
- Climate controlled
- 8' x 20' - 160 sf

Pricing starts at \$31,100

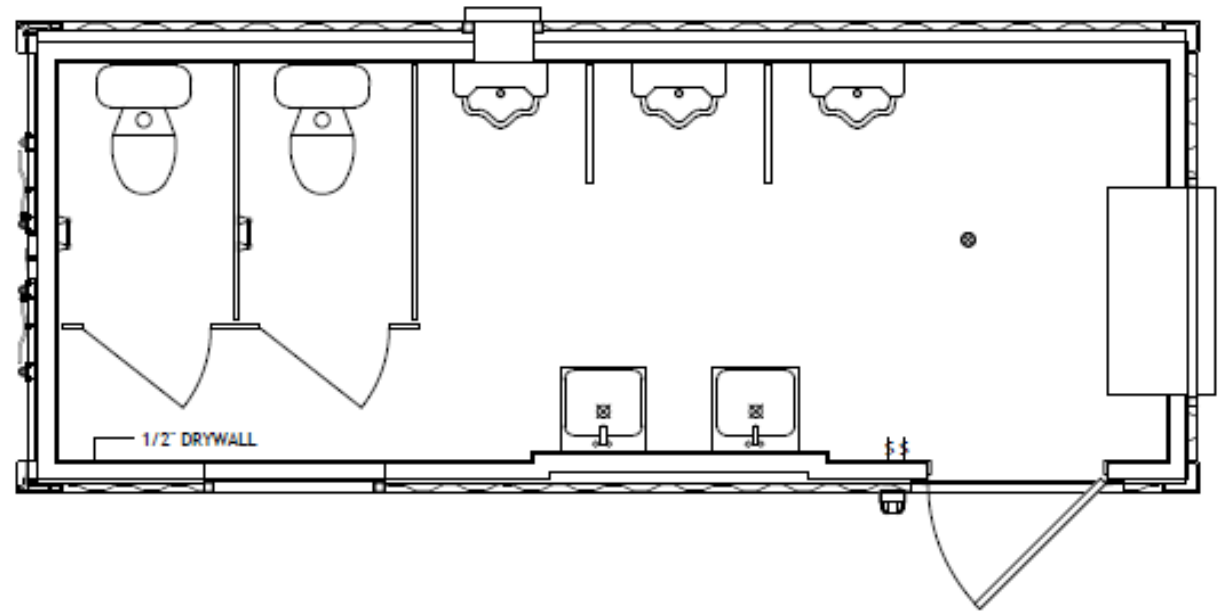

ARCHITECTURAL FLOORPLAN

Men's & Women's Restroom

Item 9501317 – Model D4540

- Men's – 4 urinals, 1 toilet, 2 sinks
- Women's – 4 toilets, 2 sinks
- Climate controlled
- 8' x 40' - 320 sf

Pricing starts at \$55,800

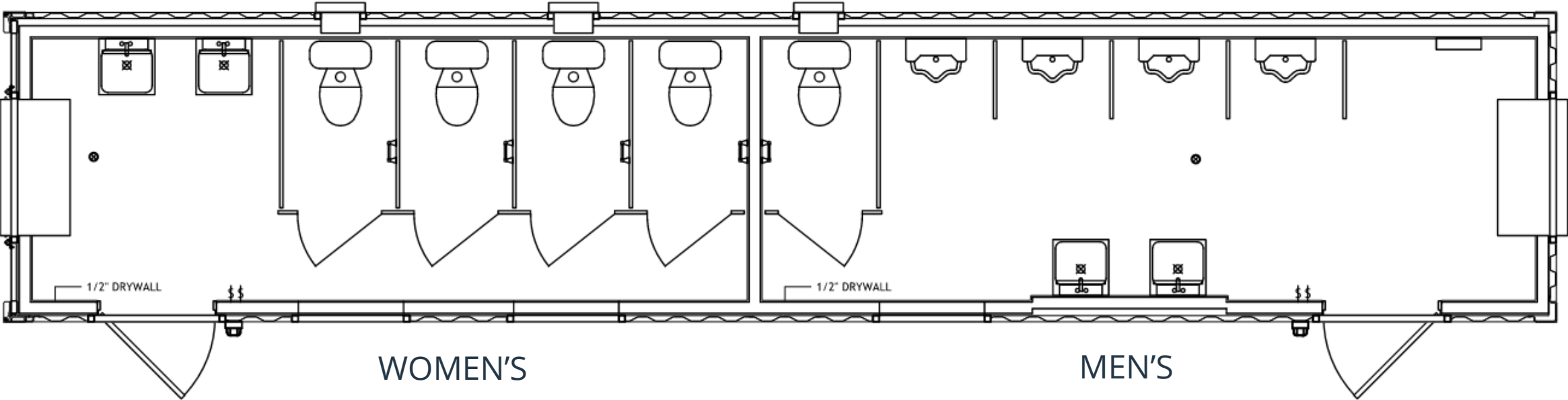

ARCHITECTURAL FLOORPLAN



Men's & Women's Restroom - ADA

Item 9501306 – Model D2520-A

- Women's – 3 toilets, 1 sink
- Men's – 2 toilets, 2 urinals, 1 sink
- Fully ADA compliant
- Climate controlled
- 8' x 40' - 320 sf

Pricing starts at \$54,800

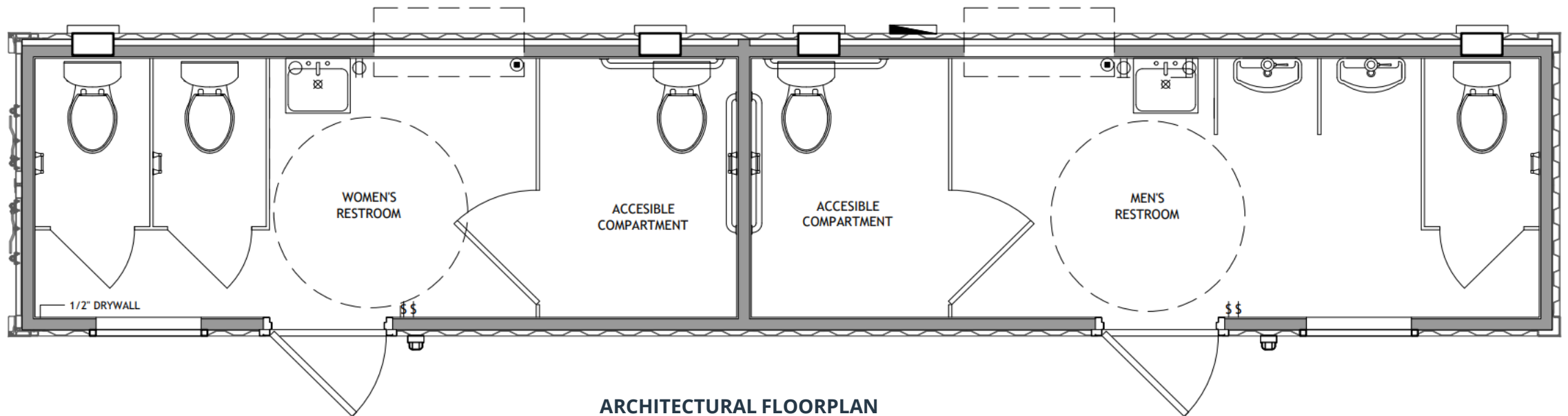

VIP SUITES, CONCESSIONS & PRESS BOXES

Ultimate Fan Accommodation

- Watch matches from uniquely comfortable setting
- Create revenue opportunities
- Add units as fan base grows



VIP Suite – Open Air

Item 9301101

- Offer loyal fans a shaded view of matches
- Semi-exclusive with 16' roll-up door
- Drive ticket sales
- 8' x 20' – 160 sf

Pricing starts at \$17,000

*Furnishings not included

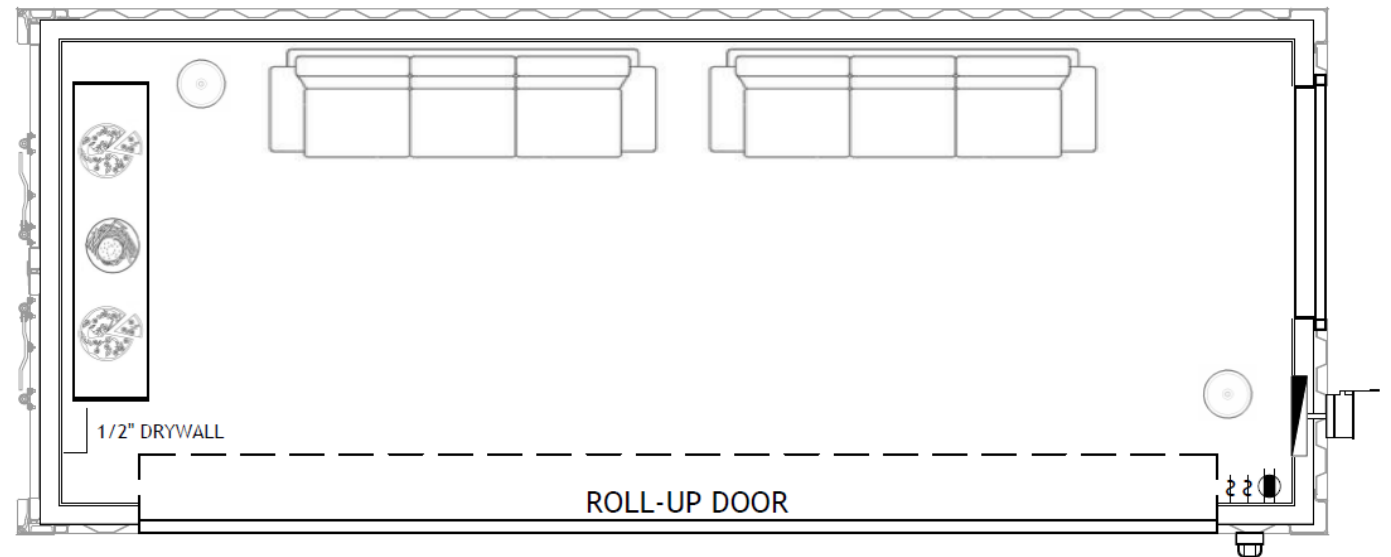

ARCHITECTURAL FLOORPLAN

VIP Suite – Climate Controlled

Item 9301102

- Create an exclusive game day experience
- Climate controlled to keep VIP fans comfortable
- Drive revenue with unique game day atmosphere
- 8' x 20' – 160 sf

Pricing starts at \$21,750

*Furnishings not included

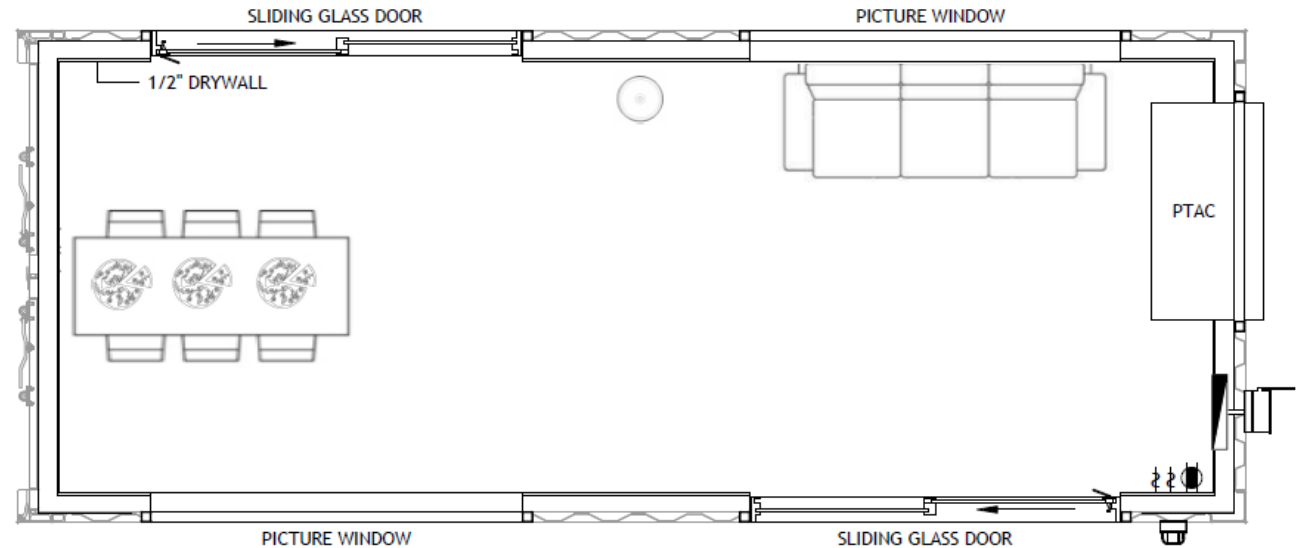

ARCHITECTURAL FLOORPLAN

Concessions

Item 9301104

- Increase game day revenue by providing vendors with concession spaces
- Climate controlled
- 8' x 20' – 160 sf

Pricing starts at \$18,750

* Add-on packages for sinks, work surfaces available

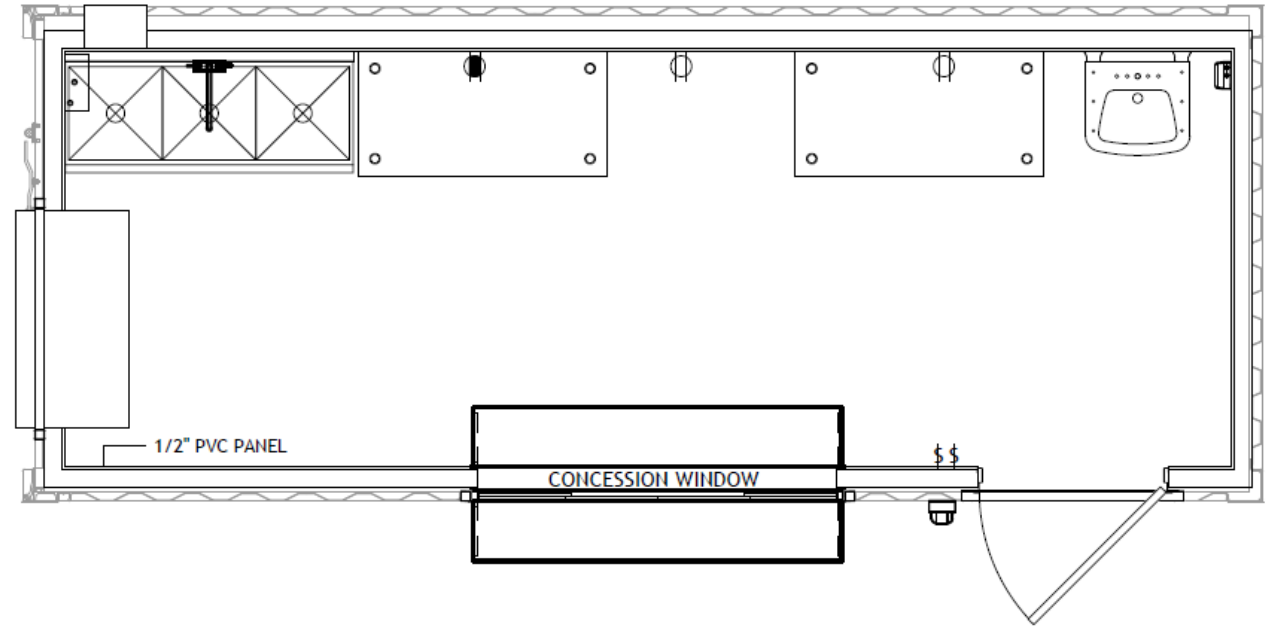

ARCHITECTURAL FLOORPLAN

Concession & Bathroom Package

Item 9301106

- Meet restroom and concession needs with single 40' container
- 20' concession space with optional amenities
- 3 private restrooms attached
- ADA-compliant design available

Pricing starts at \$63,750

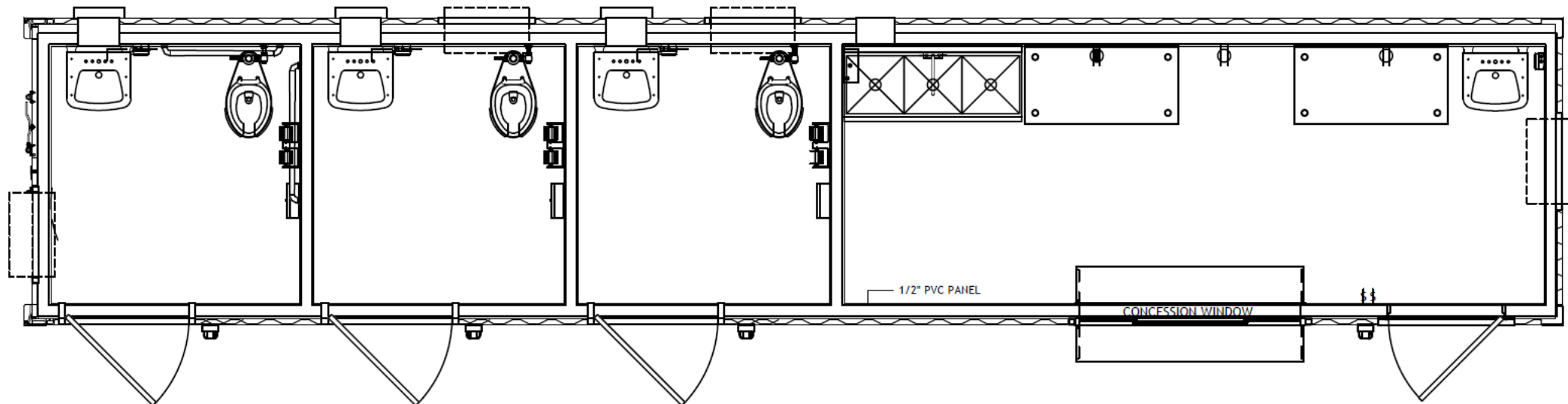

ARCHITECTURAL FLOORPLAN

Press Box

Item 9301103

- View matches through 4 sliding windows with awnings
- Climate controlled space
- 8' x 20' – 160 sf

Pricing starts at \$20,750

*Furnishings not included

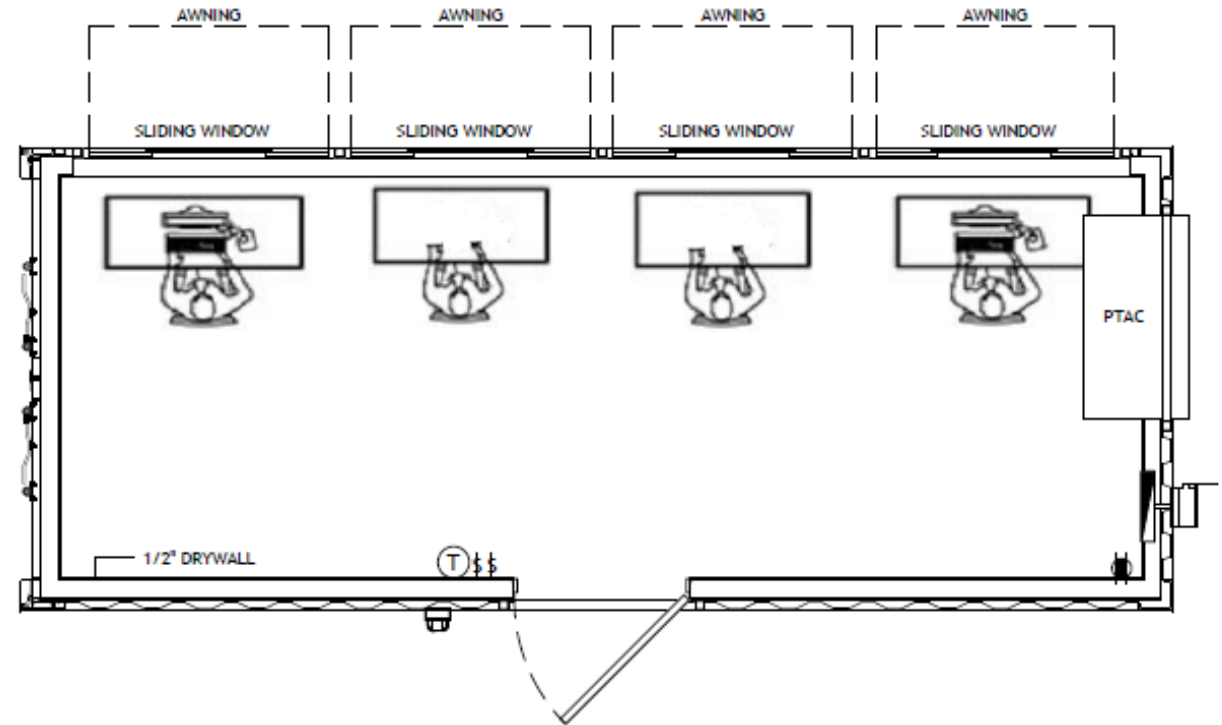

ARCHITECTURAL FLOORPLAN

Press Suite

Item 9800101

- Expand space for larger press corps
- Climate controlled
- 4 sliding windows with awnings for field visibility
- 16' x 20' – 320 sf

Pricing starts at \$44,200

*Furnishings not included

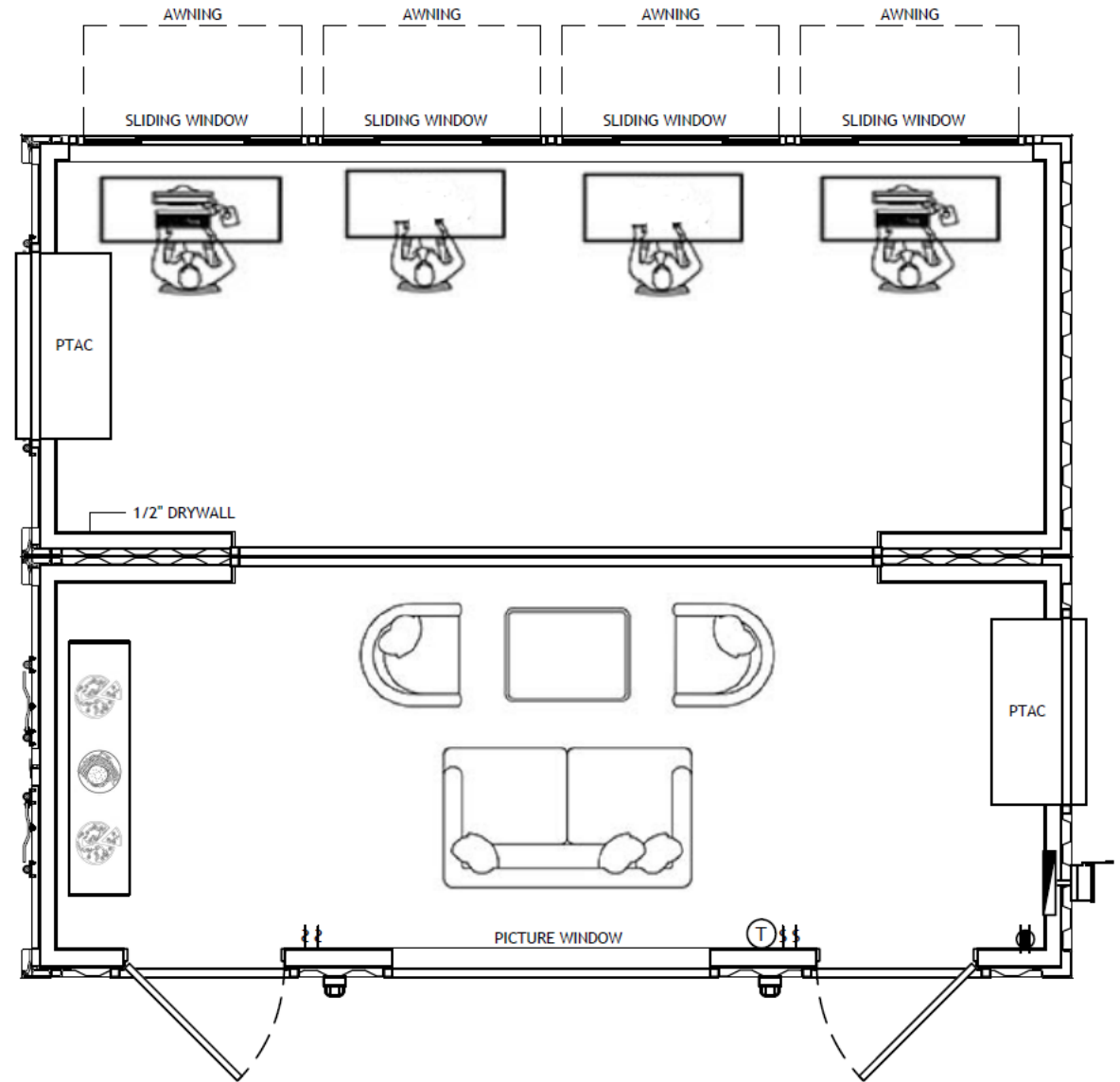

TEAM FACILITIES

Create a Team "Home"

- Give coaches a dedicated workspace
- Empower players with comfortable locker rooms
- Customize modular meeting areas

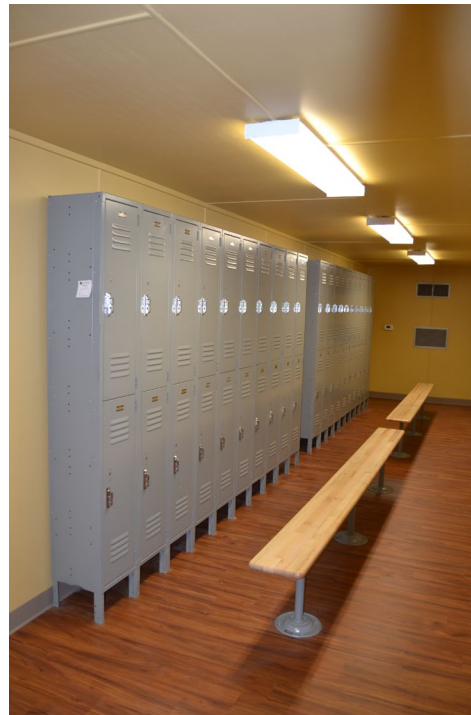

Locker Room

Item 9502401 – Model P3202

- 2 showers, 3 sinks, 2 toilets
- Common area for lockers
- Climate controlled
- 8' x 40' – 320 sf

Pricing starts at \$46,500

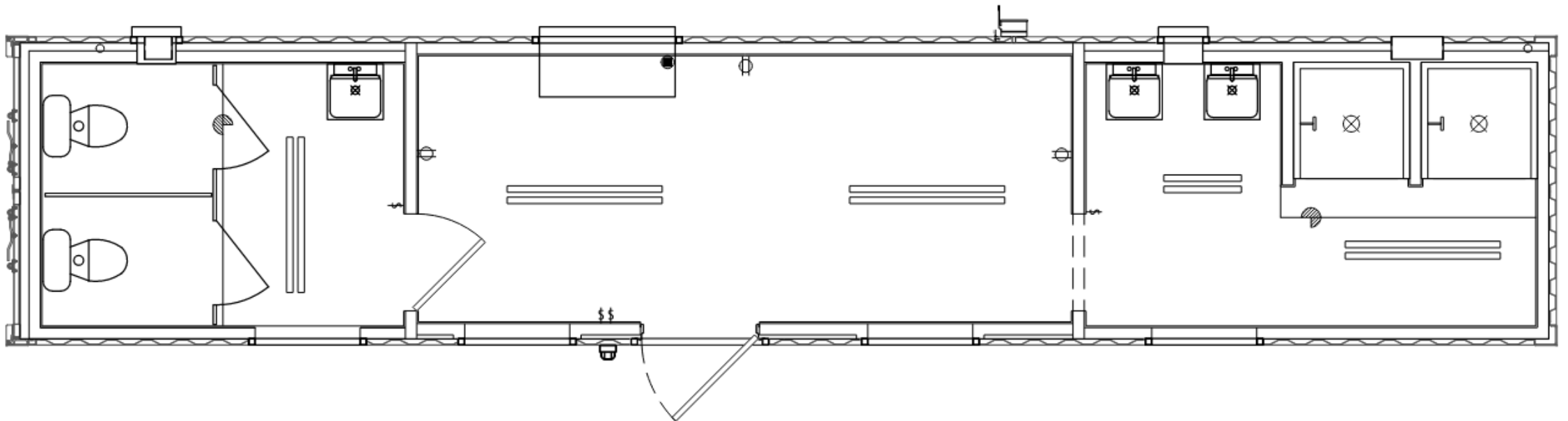

ARCHITECTURAL FLOORPLAN

Shower Room

Item 9502106 – Model P1206-Z

- 6 showers, 1 sink, 2 toilets
- Climate controlled
- 8' x 40' – 320 sf

Pricing starts at \$64,900

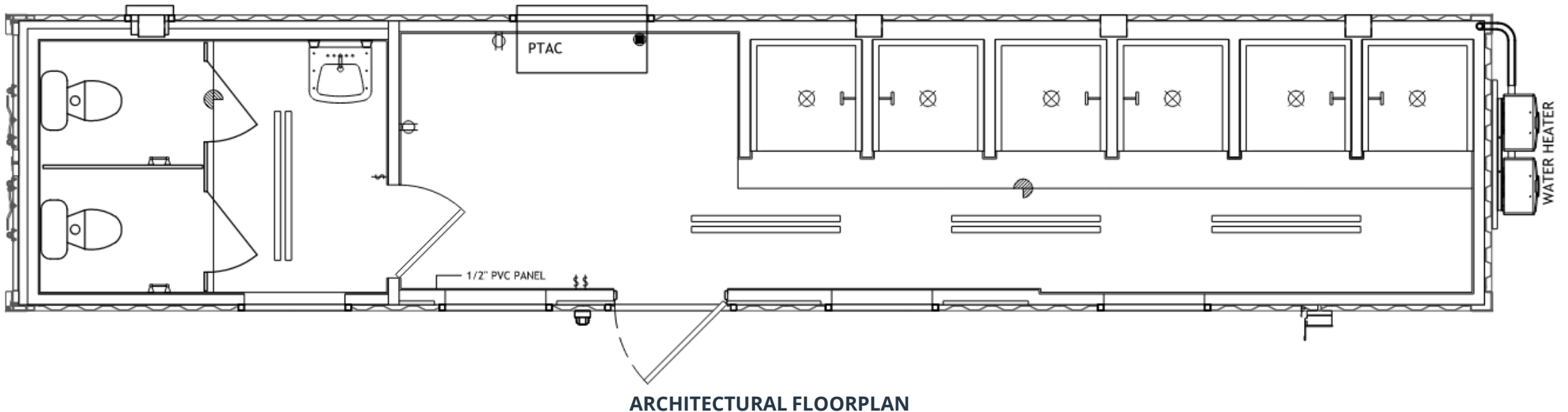

Team Office – 20'

Item 9301302

- Gathering and meeting space for teams
- Climate controlled
- 8' x 20' – 160 sf

Pricing starts at \$20,200

*Furnishings not included

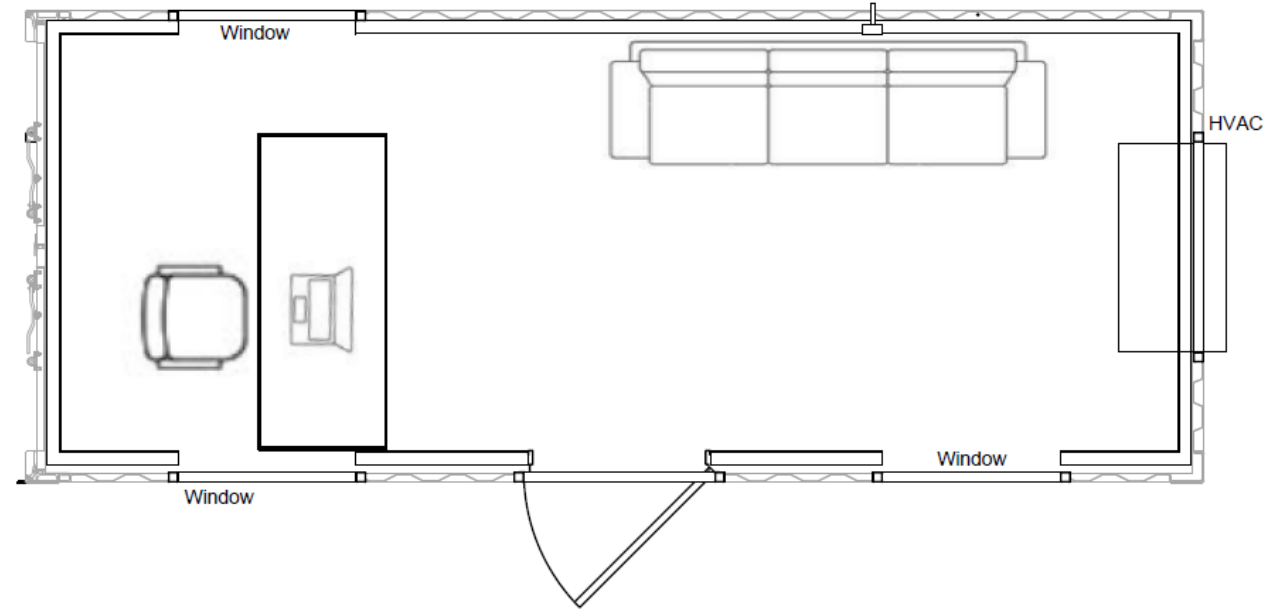

ARCHITECTURAL FLOORPLAN

Team Office – 40'

Item 9301314

- Offices for coaches
- Conference room for meetings
- Climate controlled
- 8' x 40' – 320 sf

Pricing starts at \$35,500

*Furnishings not included

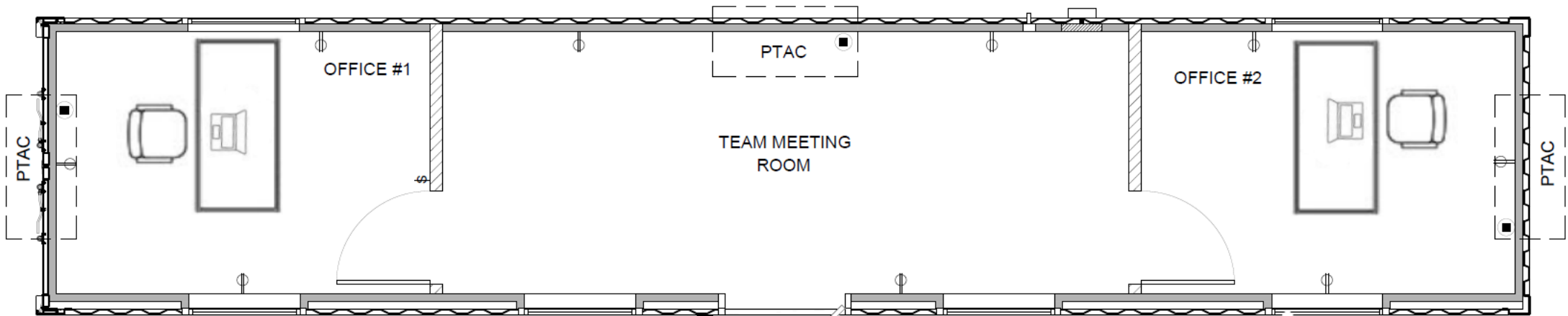

ARCHITECTURAL FLOORPLAN

Team Headquarters

Create a scalable, customizable team base that meets USL specifications.

Item 9502101

- 6 player showers, 2 coach showers
- Lockers and benches
- Meeting area for coaches and teams
- 4 toilets, 4 urinals, 6 sinks
- 32' x 40' – 1,280 sf

Pricing starts at \$240,000

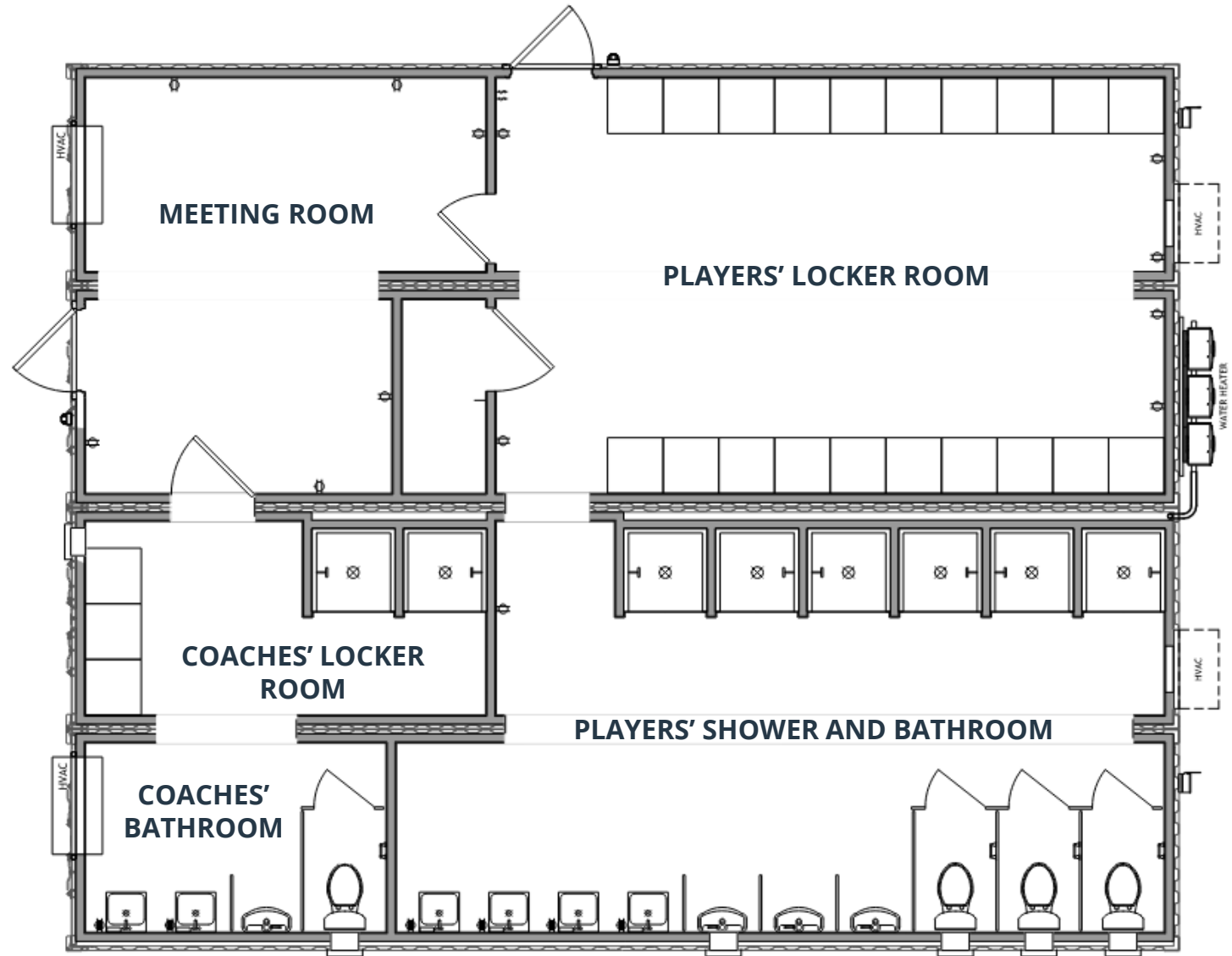

ARCHITECTURAL FLOORPLAN



CUSTOM PROJECTS

- Work with Falcon's Design Build team to create a one-of-a-kind team venue
- Engage the community, team, and fans with a unique experience
- Customize facilities with team's branding



Let's Grow the Game

We've partnered with USL to move the game of soccer forward in North America. As the preferred provider of container-based structures, our team is here to empower yours. Contact us to see how our modular structures can progress your club's success.



www.falconstructures.com/united-soccer-league | 512-231-1010