



FALCON

STRUCTURES

Multi-Containers

A photograph of a white door with a window and a keyhole. The window is rectangular and framed in black, showing a reflection of the interior. The door has a silver handle and a keyhole. The background is a light blue wall.

TABLE OF CONTENTS

[2-Story Observation Workspace](#)

[20-Foot Double Container Structure](#)

[40-Foot Double Container Structure](#)



3-20FT 2-STORY OBSERVATION WORKSPACE

7800001



FIRST FLOOR SPECS

- Built in two 20-foot standard, one-trip (close to new) containers
- Exterior Paint
- ½-inch textured and painted gypsum drywall over wood framing and batt insulation
- Three 3-foot by 3-foot operable windows
- One 3-foot wide exterior personnel door with window
- One exterior security light adjacent to the exterior personnel door
- Original marine-grade plywood or bamboo floors
- 125A capacity panel with 100A exterior disconnect
- Four standard 4-foot light fixtures, each with two 4-foot LED tubes
- Five duplex 110V outlets
- One data pass through
- Falcon cross-over electrical system
- One 2T BARD unit



SECOND FLOOR SPECS

- Built in one 20-foot standard, one-trip (close to new) container
- Exterior Paint
- 1/4-inch painted wood paneling over wood framing and batt insulation
- Two 6-foot by 3-foot fixed-pane windows
- One 3-foot wide exterior personnel door with window
- One exterior security light adjacent to the exterior personnel door
- Original marine-grade plywood or bamboo floors
- Two standard 4-foot light fixtures, each with two 4-foot LED tubes
- Five duplex 110V outlets
- One data pass through
- One 15K PTAC unit
- One OSHA Steel staircase with 4-foot landing and double handrails

7717 Gilbert Rd., Manor, TX 78653
falconstructures.com



Call us at [512.231.1010](tel:512.231.1010) or send an e-mail to
sales@falconstructures.com

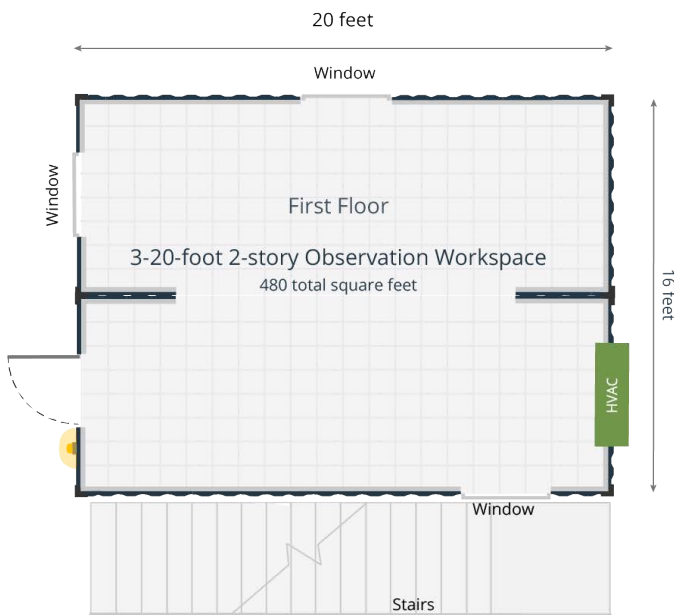

FIRST FLOOR EXTERIOR

Width	16-feet
Length	19 feet, 10.5 inches
Height*	8-feet, 6-inches

FIRST FLOOR INTERIOR

Width	14-feet
Length	18-feet, 6-inches
Height*	7-feet, 4-inches

SECOND FLOOR EXTERIOR

Width	8-feet
Length	19 feet, 10.5 inches
Height*	8-feet, 6-inches

SECOND FLOOR INTERIOR

Width	7-feet
Length	18-feet, 6-inches
Height*	7-feet, 4-inches

COMMON MODIFICATIONS



Kitchenette

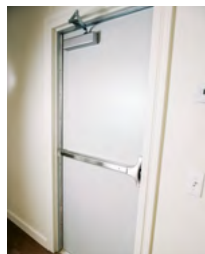

Egress Door



Bathroom



Work Space



Additional Windows



Additional Security Lights

*Heights are based off a standard shipping container. Taller high-cube containers are available upon request.

**All specifications and pricing subject to change without notice.

***Dimensions are approximate, as containers vary from manufacturer to manufacturer.



20-FOOT DOUBLE CONTAINER STRUCTURE

SPECS

- Built-in two 20-foot standard, one-trip (close to new) containers
- Exterior Paint
- 12-foot clear opening between units
- ½-inch textured and painted gypsum drywall over wood framing and batt insulation
- Two 3-foot by 3-foot windows
- Two 3-foot wide exterior personnel doors
- One exterior security light adjacent to each exterior personnel door
- Original marine-grade plywood or bamboo floors
- 125A capacity panel with 60A exterior disconnect
- Four 4-foot LED light fixtures
- Eight duplex 110V outlets
- One data pass-through
- Falcon cross-over electrical system
- Two 15K PTAC units



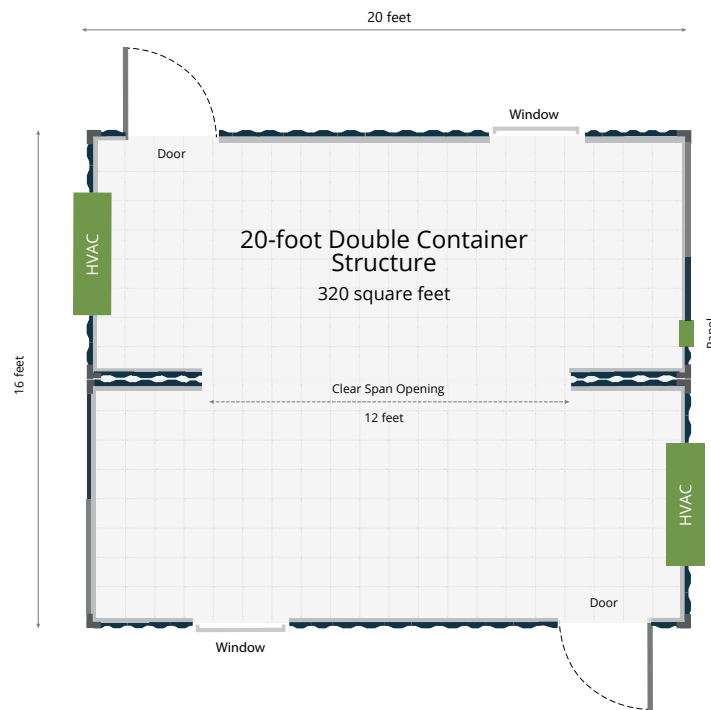

EXTERIOR

Width	16 feet
Length	19 feet, 10.5 inches
Height*	8-feet, 6-inches

INTERIOR

Width	15 feet
Length	18 feet, 6 inches
Height*	7 feet, 4 inches

*Heights are based off a standard shipping container. Taller high-cube containers are available upon request.

**All specifications and pricing subject to change without notice.

***Dimensions are approximate, as containers vary from manufacturer to manufacturer.

Want to learn more
about modified
shipping containers?

REQUEST A QUOTE



7717 Gilbert Rd., Manor, TX 78653
falconstructures.com



Call us at [512.231.1010](tel:512.231.1010) or send an e-mail to
sales@falconstructures.com



40-FOOT DOUBLE CONTAINER STRUCTURE

SPECS

- Built-in two 40-foot standard, one-trip (close to new) containers
- Exterior Paint
- Three 12-foot clear openings between units
- ½-inch textured and painted gypsum drywall over wood framing and batt insulation
- Four 3-foot by 3-foot windows
- Two 3-foot wide exterior personnel doors
- One exterior security light adjacent to each exterior personnel door
- Original marine-grade plywood or bamboo floors
- 125A capacity panel with 60A exterior disconnect
- Eight 4-foot LED light fixtures
- Twelve duplex 110V outlets
- One data pass-through
- Falcon cross-over electrical system
- Two 15K PTAC units



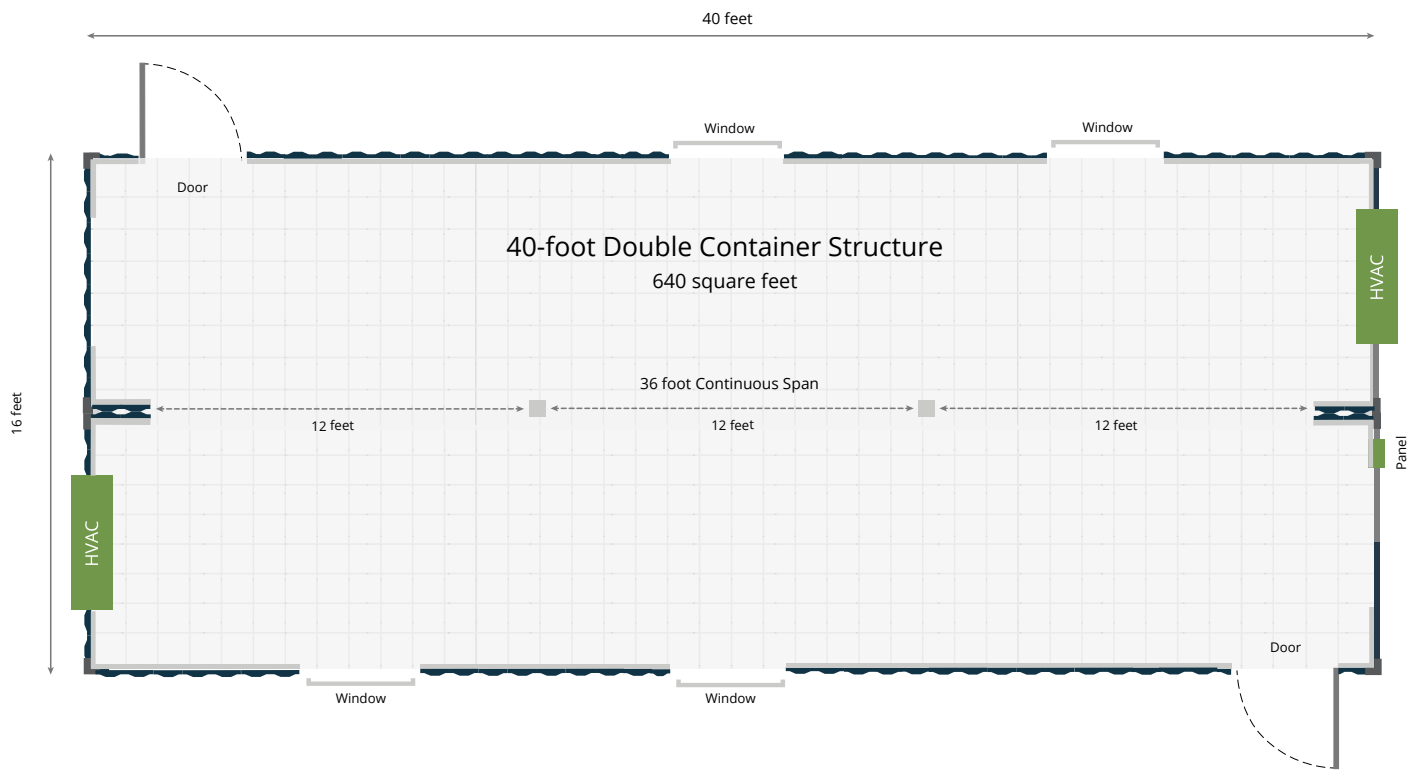

EXTERIOR

Width	16 feet
Length	40 feet
Height*	8 feet, 6 inches

INTERIOR

Width	15 feet
Length	38 feet, 7 inches
Height*	7 feet, 4 inches

*Heights are based off a standard shipping container. Taller high-cube containers are available upon request.

**All specifications and pricing subject to change without notice.

***Dimensions are approximate, as containers vary from manufacturer to manufacturer.

Want to learn more
about modified shipping
containers?

REQUEST A QUOTE



7717 Gilbert Rd., Manor, TX 78653
falconstructures.com



Call us at [512.231.1010](tel:512.231.1010) or send an e-mail to
sales@falconstructures.com